

wire	φ a
#12,#14	φ3.2
#16	φ2.8
#18	φ2.4
#20	φ2.1

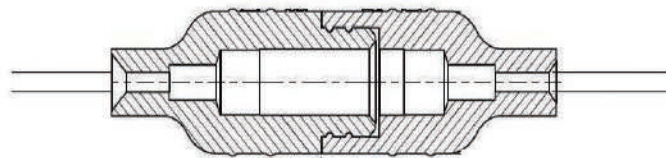
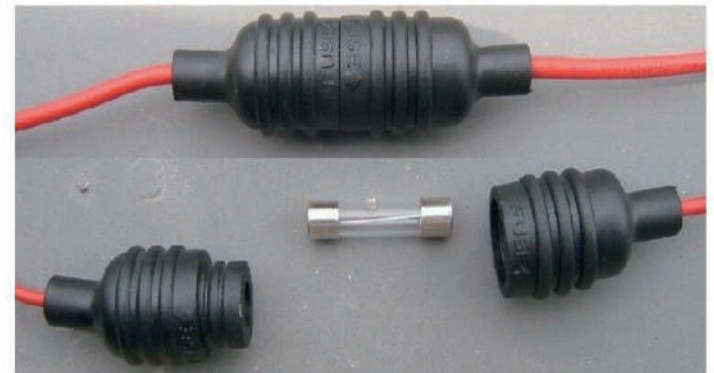
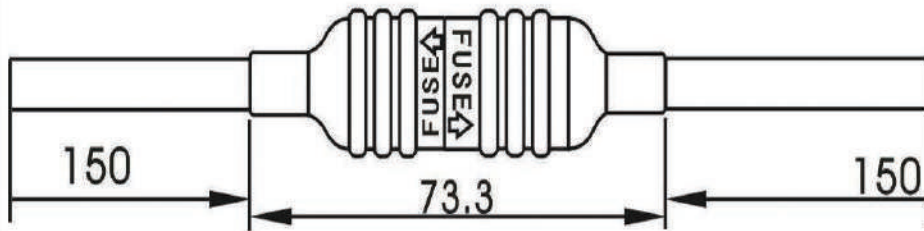
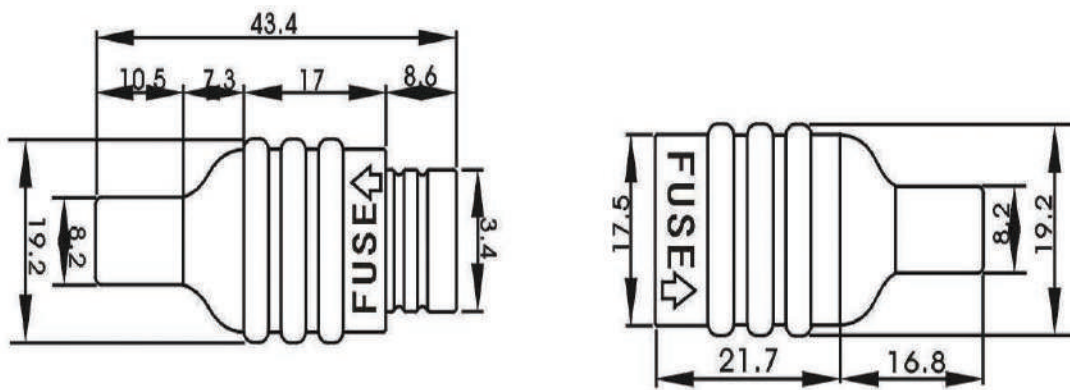

SECTION A-A:

Specifications:

Suitable Rated Current	30A Max. (This will base on the wire gauge & decide what Amp to use).
Dielectric Strength For 60 Seconds	AC 1500 V Min
Insertion & Extraction Force	1 Kg. Min
Contact Resistance At 1A DC	5mΩ Max.
Insulation Resistance At 500V DC	100MΩ Min.
Wire	Suitable For Wire #12-#22AWG (Fuse holder hole φ 2.4mm, this will base on the size of the wire & decide the size of fuse holder hole for the wire).
Type	Waterproof Type, Snap-Lock
Molded Parts	PVC
Terminals	Brass,

东莞市天瑞电子有限公司

普通公差: DIMENSION: 0~10±0.1; 10~30±0.3; 30~100±0.5.
COMMON TOLERANCE: ROUND: ±0.3max. ANGULAR: ±1°.

UNIT: mm.

投影
PROJECTED
设计
DRAWN BY
审核
CHECKED BY

肖永明
刘维中

比例
SCALE
日期
DATE
核准
APPROVAL BY

FREE
2010. 11. 16
孙联虎

品名
PRODUCT NAME
料号
MODEL NO.
规格
RATING

IN LINE FUSEHOLDER
JH308
6X30 fuse